



NATIONAL ACADEMY OF ENGINEERING

2018 ANNUAL MEETING

September 30–October 1, 2018
Washington, DC

CYBERSECURITY



The National Academies of
SCIENCES • ENGINEERING • MEDICINE



NATIONAL ACADEMY OF ENGINEERING 2018 ANNUAL MEETING

September 30–October 1, 2018
Washington, DC

CONTENTS

Sunday, September 30

Public Program	2
Chair's Remarks	2
President's Address	3
Induction Ceremony	4
Awards Program	5
Plenary Session	8

Monday, October 1

Business Session10
Public Forum10
Section Meetings14
Reception & Dinner Dance14

General Information

Meeting Services14
Section Chairs15
Guest Program16
Registration17
Shuttle Bus Service17
Guest Tour Bus Service17
NAS Building Map18
Area Map19
2017 Honor Roll of Donors20

10:00 am–4:00 pm **Registration** **NAS 120**

10:30 am–11:45 am **Brunch Buffet** **West Lawn**

10:30 am–11:45 am **Tax and Financial Planning Seminar** **Members' Room**
(advance registration required; brunch included)

Led by Jamie M. Killorin, CPA/PFS, CGMA, CFP®
Director of Gift Planning, National Academies of Sciences, Engineering, and Medicine

The Tax Cuts and Jobs Act of 2017 changed the rules for tax, financial, and charitable planning. Learn what these new rules mean for you and strategies for your planning.

Jamie Killorin is a licensed certified public accountant (CPA/PFS) and certified financial planner (CFP®) with over 20 years of tax, financial advisory, and wealth management experience. She offers seminars on financial topics, charitable planning, and professional ethics and has a doctorate from George Washington University in human and organizational learning.

12:00 noon–2:00 pm **PUBLIC PROGRAM** **Fred Kavli Auditorium**



Chair's Remarks
Mr. Gordon R. England
Chair, National Academy of Engineering

Gordon R. England is chair of the board of PFP Cybersecurity and a partner of Dyno-Tech, LLC. Previously, he served as deputy secretary of defense (2005–09) and, as secretary of the Navy (2001–06), was credited with developing successful surge plans for America's fleet, strengthening the ties between the Navy and Coast Guard, and increasing assistance to the US Marines on the front lines in Iraq. He was the first deputy secretary of the Department of Homeland Security (2003).

Mr. England's business career spanned over 40 years as an engineer and senior executive, largely at General Dynamics, where he was executive vice president of the Information Systems & Technology Sector (1997–2001); president of the GD Fort Worth Aircraft Company (later Lockheed) (1991–95), responsible for all domestic and international aircraft programs, including the F-16 fighter; president (1990–91) and vice president, engineering (1986–90), of GD Land Systems Company; and director of avionics of the Fort Worth Company (1980–86). He began his career at Honeywell, where he was an engineer on the Project Gemini space program.

Mr. England was elected to the NAE in 2012 for advances in digital avionics for aircraft, land, and naval platforms. He cochaired the Academies' Government-University-Industry Research Roundtable and served on the NAE Aerospace Engineering Peer Committee, organizing committee for the Workshop on Trends in the Innovation Ecosystem: Can Past Successes Help Inform Future Strategies?, Committee on Talent: Assessing and Meeting National Workforce Needs, and Committee on Fault Isolation.



He has been active in a variety of civic, charitable, and government organizations, including serving as a city councilman. He chairs the board of the US Naval Institute Foundation, serves on the boards of the Community Learning Center and Glilot Capital Partners, advisory council of Business Executives for National Security, and University of Maryland trustees board, and is an honorary trustee on the board of directors of the National Museum of the Pacific War. He is vice president of the Academy of Medicine, Engineering, and Science of Texas. He served on the USO board of governors, DOD Defense Science Board, MERRA—Michigan R&D Cooperative (chair), Michigan Chapter of ADPA (president), Defense Manufacturing Board on Concurrent Engineering, Engineering Board of Advisors of the Universities of Texas and Michigan and Oakland University, board of Goodwill (vice chair), and CACI board of directors.

Mr. England has been recognized for numerous professional and service contributions, with an honorary doctor of science, Oakland University (2003), IEEE Centennial Award, Commander Cross—Republic of Poland, Silver Knight of Management Award from the National Management Association, DOD Distinguished Public Service Award, Henry M. Jackson Award, NIDA Dwight Eisenhower Award, USCG Distinguished Public Service Award, Navy League David M. Thompson Award, Naval Order of US Admiral George Dewey Award, 2005 Charles Francis Adams Award, Department of VA Exceptional Service Award, Armed Forces Foundation Award, Boy Scouts of America Distinguished Citizen Award Silver Beaver, Union League Lincoln Award, Goodwill Industries Person of the Year, and USO Distinguished Citizen Award. He is a member of Beta Gamma Sigma (business), Omicron Delta Kappa (leadership), and Eta Kappa Nu (engineering).

He received a BS degree in electrical engineering from the University of Maryland, College Park in 1961, and an MBA from Texas Christian University in 1975.

President's Address
Dr. C. D. Mote, Jr.
President, National Academy of Engineering
Vice Chair, Governing Board of the National Research Council

C. D. Mote, Jr. is president of the National Academy of Engineering and Regents' Professor on leave from the University of Maryland, College Park.

Dr. Mote is a native Californian who earned his BS, MS, and PhD degrees at the University of California, Berkeley in mechanical engineering between 1959 and 1963. After a postdoctoral year in England and three years as an assistant professor at the Carnegie Institute of Technology in Pittsburgh, he returned to Berkeley to join the faculty in mechanical engineering for the next 31 years. He and his students investigated the dynamics, stability, and control of high-speed rotating and translating continua (e.g., disks, webs, tapes, and cables) as well as biomechanical problems associated with snow skiing. He coined the area called "dynamics of axially moving materials" encompassing these systems. Fifty-eight PhD students earned their degrees under his mentorship. He held an endowed chair in mechanical systems at Berkeley and chaired the Mechanical Engineering Department from 1987 to 1991, when the National Research Council (NRC) ranked its graduate program effectiveness highest nationally. Because of his success at raising funds for mechanical engineering, in 1991 he was appointed vice chancellor to create and lead a \$1 billion capital campaign, which raised \$1.4 billion.

In 1998 Dr. Mote was recruited to the presidency of the University of Maryland, College Park, a position he held until 2010 when he was appointed Regents' Professor. His goal for the university was to elevate its self-expectation of achievement and its national and global positions through proactive initiatives. During his tenure the number of Academy members on the faculty tripled, three Nobel laureates were recognized, and an accredited school of public health and a new department of bioengineering were created. In addition, he founded a 130-acre research park next to the campus, faculty research funds increased by 150 percent, and partnerships with surrounding federal agencies and with international organizations expanded greatly. The number of students studying abroad tripled, and he created an annual open house day that attracts over 100,000 visitors, founded a charitable foundation for the campus whose board of trustees launched and led a successful \$1 billion capital campaign, and took to lunch every student that wanted to go. The Academic Ranking of World Universities ranked the campus #36 in 2010 and its Engineering School #13.

The NAE elected him to membership in 1988 and to the positions of councillor (2002–08), treasurer (2009–13), and president for a six-year term beginning July 1, 2013. He has served on the NRC governing board executive committee since 2009.

Dr. Mote's recognitions include the NAE Founders Award, the American Society of Mechanical Engineers (ASME) Medal, and the Humboldt Prize of the Federal Republic of Germany. He is an honorary fellow of ASME, honorary member of the American Society for Engineering Education, and fellow of the American Academy of Arts and Sciences, American Academy of Mechanics, Acoustical Society of America, and American Association for the Advancement of Science. He was elected to the Chinese Academy of Engineering in 2015, made an honorary academician of the Academia Sinica, Taiwan, in 2016, and in 2017 elected a fellow of the National Academy of Inventors. He holds four honorary doctorates and three honorary professorships.

As president of the NAE Dr. Mote is committed to ensuring highly competitive talent in the US engineering workforce, facilitating public understanding of engineering, demonstrating how engineering creates a better quality of life, and engaging the Academy in global engineering issues in support of national interests. A highlight of global engineering engagement is the promotion of the NAE's 14 Grand Challenges for Engineering, whose solutions are needed to achieve the global vision "Continuation of life on the planet, making our world more sustainable, safe, healthy, and joyful."

Induction Ceremony for the NAE Class of 2018



Dr. Alton D. Romig, Jr.
Executive Officer, National Academy of Engineering

Alton D. Romig, Jr. is the executive officer of the National Academy of Engineering. In this capacity he is the chief operating officer responsible for the program, financial, and membership operations of the Academy, reporting to the NAE president.

He was previously vice president and general manager of Lockheed Martin Aeronautics Company Advanced Development Programs, better known as the Skunk Works®. He spent the majority of his career at Sandia National Laboratories, operated by the Lockheed Martin Corporation, having joined Sandia as a member of the technical staff in 1979 and moved

through a succession of R&D management positions leading to his appointment as executive vice president in 2005. He served as deputy laboratories director and chief operating officer until 2010, when he transferred to the Skunk Works.

Dr. Romig serves or has served on a number of advisory committees, including those at the University of Washington, MIT, Ohio State, Purdue, Georgia Tech, the Colorado School of Mines, and Sandia National Labs. He is also visiting associate of applied physics and materials science at Cal Tech. He serves on the board of directors of Football Research, Inc., a nonprofit created and supported by the National Football League to review engineering technology to improve the safety of the sport.

Dr. Romig is a fellow of TMS, IEEE, AIAA, and AAAS and a fellow and honorary member of ASM International. He was elected to the NAE in 2003 and the Council on Foreign Relations in 2008. He was awarded the ASM Silver Medal for Materials Research in 1988. He received his BS (1975), MS (1977), and PhD (1979) in materials science and engineering from Lehigh University.

2:00–2:30 pm

Break (NAE Class of 2018 and Anniversary Members group photo)

Class of 2018 and 25th Anniversary Members (Class of 1993) proceed with NAE staff guidance to the Constitution Avenue Lobby.

2:30–4:00 pm

Awards Program

Kavli Auditorium

2:30–2:50 pm

2018 Simon Ramo Founders Award Recipient



Professor Thomas Kailath
Hitachi America Professor of Engineering Emeritus
Department of Electrical Engineering
Stanford University

The Simon Ramo Founders Award, the oldest award presented by the National Academy of Engineering, was established in 1965 to honor an outstanding NAE member or foreign member who has upheld the ideals and principles of the NAE through professional, educational, and personal achievement and accomplishment.

Thomas Kailath, recipient of the 2018 Simon Ramo Founders Award, is being honored "for pioneering contributions to diverse fields of electrical engineering and for leadership in technology commercialization and in engineering education, guiding a stellar array of young scholars."

Professor Kailath began his career at the Digital Communications Group at the Jet Propulsion Laboratory in Pasadena, where he also held a visiting appointment at Caltech. In 1963 he joined Stanford University as an associate professor of electrical engineering, was promoted to professor in 1968, and in 1988 he was appointed the first holder of the Hitachi America Professorship in Engineering. As director of the Stanford Information Systems Laboratory (1971–81), he built it into a leading center for communications, control, and signal processing research before becoming associate chair of the Electrical Engineering Department (1981–87). He assumed emeritus status in 2001, but was recalled to continue his research and writing.

Professor Kailath's research and teaching have spanned a number of engineering and mathematical disciplines, with the major focus of his research changing roughly every decade. In the 1960s he contributed to information and communication theory. Next he turned his attention to state space estimation and control. In the 1980s he led a large research group in four major areas: smart antenna array processing, adaptive filtering theory, special purpose VLSI architectures for signal processing, and displacement structure theory for fast matrix and linear algebra computations. In the 1990s his group made contributions to two areas of semiconductor manufacturing: rapid thermal processing and optical lithography, where they showed how to break the widely believed 100 nm barrier for the smallest achievable critical dimensions.

His work with a stellar array of over 100 doctoral and postdoctoral scholars has led to over 300 journal papers, a dozen patents, and several books and monographs, including the textbooks *Linear Systems* (1980) and *Linear Estimation* (2000). With his students, Professor Kailath cofounded several companies, two of which went public, while the others were acquired; his former students have formed over 20 companies themselves.

Professor Kailath received a 2012 National Medal of Science "for transformative contributions to the fields of information and system science, for distinctive and sustained mentoring of young scholars, and for translation of scientific ideas into entrepreneurial ventures that have had a significant impact on industry." In 2017 he was honored with the Marconi Society's Lifetime Achievement Award. He has also received the IEEE's Education and Signal Processing Medals and its highest award, the IEEE Medal of Honor, "for exceptional contributions to the development of powerful algorithms for communications, control, computation, and signal processing." Other major recognitions include election to the NAE, National Academy of Sciences, and American Academy of Arts and Sciences; foreign membership in, among others, the Royal Society of London, Royal Spanish Academy of Engineering, Indian National Academy of Engineering, and Indian National Science Academy; the Padma Bhushan, India's third-highest civilian award, presented by the country's president, and a BBVA Foundation Frontiers of Knowledge Award for Information and Communication Technologies. In addition to being a fellow of the IEEE, Institute of Mathematical Statistics, Society for Industrial and Applied Mathematics, and American Mathematical Society, Professor Kailath has held Guggenheim, Churchill, and Humboldt fellowships.

He received his BE (telecom) from the College of Engineering, Pune, India, in 1956 and MS and ScD from the Massachusetts Institute of Technology in 1959 and 1961, as well as several honorary degrees, most recently from the Technion and the National Technical University of Athens.

2:50–3:10 pm

2018 Arthur M. Bueche Award Recipient

Dr. Venkatesh Narayanamurti
Benjamin Peirce Research Professor of Technology and Public Policy
Paulson School of Engineering and Applied Sciences
and Kennedy School of Government
Harvard University

The Arthur M. Bueche Award of the National Academy of Engineering recognizes an engineer who has been actively involved in determining US science and technology policy, promoting technological developments, and contributing to the enhancement of relations between industries, government, and universities.



Venkatesh Narayanamurti, recipient of the 2018 Arthur M. Bueche Award, is being honored "for seminal contributions to condensed matter physics and visionary leadership of multidisciplinary research in industry, academia, and national labs that generated research and engineering advances."

Venkatesh "Venky" Narayanamurti is the Benjamin Peirce Research Professor of Technology and Public Policy at Harvard. He was previously the John L. Armstrong Professor and founding dean of the School of Engineering and Applied Sciences (SEAS), professor of physics, dean of physical sciences at Harvard, and, in 2009–15, director of the Science, Technology and Public Policy Program at the Harvard Kennedy School. He was dean of the University of California, Santa Barbara (UCSB) College of Engineering (1992–98), vice president for research at Sandia National Laboratories (1987–92), and spent much of his scientific research career at AT&T Bell Laboratories (1968–87), where he became director of the Solid State Electronics Research Laboratory (1981–87).

He is credited with developing the field of phonon optics—the manipulation of monoenergetic acoustic beams at terahertz frequencies—and is active in the field of semiconductor nanostructures.

As dean of Harvard's SEAS for 10 years, he directed the renewal and expansion of the former division, its transition to a school, the recruitment of junior and senior faculty, and a 60 percent growth in sponsored research. He was an early champion of interdisciplinary initiatives and collaboration, reaching out to colleagues in the Faculty of Arts and Sciences as well as Harvard's Medical School, Business School, and School of Public Health to establish new partnerships. Under his leadership, SEAS faculty developed creative and innovative programs to attract students, including new courses of study in computer science, electrical engineering, and bioengineering at the graduate and undergraduate levels.

At UCSB he recruited a large number of faculty, fostered interdisciplinary research, and nurtured entrepreneurship and collaborations with industry. His name lives on in the university's Venky Narayanamurti Entrepreneurial Leadership Award ("the Venky") and first endowed chair in computer science.

Dr. Narayanamurti has authored more than 240 scientific papers in different areas of condensed matter and applied physics and technology innovation policy. He lectures widely on solid state, computer, communication, and energy technologies as well as on the management of science, technology, and public policy, and has served on numerous advisory boards of the federal government, research universities, professional societies, national laboratories, and industry.

In addition to the NAE, he is an elected member of the Royal Swedish Academy of Engineering Sciences and a fellow of the American Academy of Arts and Sciences, American Physical Society, American Association for the Advancement of Science, Institute of Electrical and Electronics Engineers, Indian Academy of Sciences, and Indian National Academy of Engineering.

He earned his bachelor's (1958) and master's (1960) degrees from St. Stephen's College, Delhi University, and his PhD (1965) from Cornell University, all in physics.

3:10–4:00 pm

2018 Bernard M. Gordon Prize for Innovation in Engineering and Technology Education Lecture



The Bernard M. Gordon Prize for Innovation in Engineering and Technology Education recognizes new modalities and experiments in education that develop effective engineering leaders. It focuses on innovations such as curricular design, teaching methods, and technology-related learning that strengthen students' capabilities and desire to grow into leadership roles.

This year's Bernard M. Gordon Prize for Innovation in Engineering and Technology Education recognized Stanford University educator **Paul G. Yock** "for the development and global dissemination of Biodesign, a biomedical technology program creating leaders and innovations that benefit patients."

Paul G. Yock is the Martha Meier Weiland Professor of Medicine and founding cochair of Stanford University's Department of Bioengineering, with a courtesy appointment in the Department of Mechanical Engineering. He is also the founder and director of the Stanford Byers Center for Biodesign. He previously founded Cardiovascular Imaging Systems (acquired by Boston Scientific) and cofounded several other medical technology companies. The main focus of his research has been intravascular ultrasound.

Dr. Yock is known internationally for his work in inventing, developing, and testing new devices, including the Rapid Exchange™ stenting and balloon angioplasty system, now the primary system in use worldwide. He also invented a Doppler-guided access system known as the Smart Needle™ and PD-Access™. Among his 50 US patents, he wrote the fundamental patents for mechanical intravascular ultrasound imaging, for which he helped conduct the initial clinical trials.

He has authored over 300 peer-reviewed publications, chapters, and editorials, and two textbooks. Recent awards include the Transcatheter Therapeutics (TCT) Career Achievement Award, the American College of Cardiology Distinguished Scientist Award, and an honorary doctorate from Amherst College. He is a member of the NAE and Association of American Physicians.

After completing his undergraduate and graduate studies at Amherst College and Oxford, respectively, Dr. Yock received his MD from Harvard Medical School, followed by internship and residency training at the University of California, San Francisco, and a fellowship in cardiology at Stanford. He began his faculty career as an interventional cardiologist at UCSF and moved to Stanford in 1994.

4:00–4:30 pm

Break

4:30–5:30 pm

Plenary Speakers

Introduction
Dr. C. D. Mote, Jr.
President, National Academy of Engineering



Ms. Diane B. Greene
Chief Executive Officer, Google Cloud
Providing Security at Scale in the Cloud and the Regulatory Considerations

Diane Greene is CEO of Google Cloud and a director of Alphabet. Before Google, she cofounded and ran three technology companies: VMware, which she took public for a \$19.1B first-day closing valuation; Vxtreme, a low-bandwidth streaming video company that was bought by Microsoft; and Bebop, a software-as-a-service (SaaS) startup acquired by Google. She previously worked at Sybase, Tandem, and SGI as a software engineer and, before that, as a naval architect in the shipping and offshore oil industries. She also ran engineering for Windsurfer International.

In addition to her service on the board of Alphabet, Ms. Greene is a lifetime member of the MIT Corporation, sits on the supervisory board of SAP, and is a member of the UC Berkeley School of Engineering advisory committee. She served on the board of Intuit from 2006 through 2017.

In 2017 she received the Anita Borg Institute Technical Leadership Award and a University of Vermont honorary doctor of science. In 2018 she was elected to the NAE.

Ms. Greene has an MS in computer science from the University of California, Berkeley, an MS in naval architecture from MIT, and a BS in mechanical engineering from the University of Vermont. She is married with two children and is a lifelong sailor. She was the 1976 Women's National Dinghy Champion.



Mr. Mike Walker
Principal Researcher, Microsoft Research NExT
Securing the IoT Explosion with Automation

Mike Walker is a principal researcher at Microsoft working on security AI. Before joining Microsoft, he led DARPA's Cyber Grand Challenge, a two-year \$58M contest to construct and compete the first prototypes of reasoning cyberdefense AI. In 2016 at the DEF CON hacking contest, these prototypes took their first flight into the game of hackers, Capture the Flag (CTF), landing zero-day exploits and writing patches in a fully autonomous battle.

Mr. Walker has worked in a policy advisory role, testifying to the President's Commission on Cybersecurity and serving as a contributor and panelist to CSIS's Surviving on a Diet of Poisoned Fruit. Before joining DARPA he worked as a research lab leader and principal vulnerability researcher focusing on tools to amplify vulnerability research abilities with the power of supercomputer automation. He has played in DEF CON CTF finals, coached CTF teams, and built CTFs throughout his career.

He received his BS in computer science from Case Western Reserve University.

5:30–7:00 pm

Reception

West Lawn

6:00–9:00 pm

Golden Bridge Society Reception and Dinner
(by invitation)

Offsite

7:00–8:30 am	Continental Breakfast	West Lawn
	Foreign Secretary's Breakfast (by invitation only to the foreign members)	Members' Room
	Home Secretary's Breakfast (by invitation)	Lecture Room
8:30–9:30 am	NAE Business Session (members and foreign members only)	Kavli Auditorium
9:30 am–12:30 pm	Forum: Privacy and Security in the 21st Century – Who Knows and Who Controls?	Kavli Auditorium
	Welcome Dr. C. D. Mote, Jr. President, National Academy of Engineering	
	Dr. Batya Friedman Professor, University of Washington Information School <i>Engineering with Moral and Technical Imagination</i>	
	Ms. Aanchal Gupta Director of Security, Facebook <i>Security at Scale</i>	
	Dr. Lea Kissner Global Lead of Privacy Technologies, Google <i>Building Privacy, Security, and Respect into Systems</i>	
	Mr. Mike Walker Principal Researcher, Microsoft Research NExT <i>Securing the IoT Explosion with Automation</i>	
	Moderator: Mr. Ali Velshi MSNBC Anchor and Business Correspondent NBC News and MSNBC	
	There will be a 20-minute break during the program.	



Batya Friedman is a professor in the Information School and holds adjunct appointments in the Allen School of Computer Science & Engineering and Department of Human-Centered Design and Engineering at the University of Washington. She codirects the Value Sensitive Design Lab and the UW Tech Policy Lab.

Dr. Friedman pioneered value sensitive design (VSD), an approach to account for human values in the design of technology. First developed in human-computer interaction, VSD has since been used in architecture, civil engineering, computational linguistics, computer security, energy, human-robotic interaction, information management, legal theory, moral philosophy, and transportation. Dr. Friedman has worked on technologies and values in a wide range of systems, from security for implantable medical devices to informed consent for cookies and web browsers, reputation in knowledge base systems, privacy in mobile technology, and equitable representation in large-scale computer simulation for land use and transportation planning.

To bring VSD into engineering and tech policy research and practice, she has developed practical methods and toolkits. Among these, *Envisioning Cards* help technologists consider stakeholders, values, time, and pervasive uptake in their technical work; *Security Cards*, with a focus on threat analysis, help to develop a security mindset; and *Diverse Voices* aims to create more inclusive tech policy. Her new book *Value Sensitive Design: Shaping Technology with Moral Imagination* will be published by MIT Press in early spring 2019.

Dr. Friedman is currently working on multilifespan design—generating design knowledge for envisioning and building information systems to support sociotechnical solutions as they unfold over longer periods of time, on the order of 50 or 100 years. *Voices from the Rwanda Tribunal*, which explores the design of information systems to support transitional justice and healing from cyclical violence and genocide, is a first project in this multilifespan design research program.

Among her honors, Dr. Friedman was selected as the University of Washington's University Faculty Lecturer and received the ACM SIGCHI Social Impact Award in 2012. She is also a sculptor and mixed media artist. She received her BA and PhD from the University of California at Berkeley.



Aanchal Gupta is director of security at Facebook, leading a global team responsible for assessing and mitigating security risks across Facebook. Her team provides security guidance to the company's diverse product offerings, including Messenger, Instagram, Oculus, and WhatsApp, and is responsible for ensuring the security of Facebook's corporate infrastructure, defining security policy, red-team exercises, vendor security reviews, and ensuring compliance. She is passionate about building diverse teams, and her team runs security programs and operations that partner with universities to build a diverse pipeline of security experts.

Before joining Facebook, Ms. Gupta was chief information security officer at Microsoft for Skype and Skype for Business. In this role she managed several broad areas, including security, privacy, compliance, online safety, efforts to fight abuse, and business continuity. Before joining Microsoft, she led Yahoo's Global Identity team, contributing to authentication and authorization open standards such as OpenID and OAuth.

Ms. Gupta has more than two decades of experience leading geographically distributed teams developing secure and trustworthy software used by billions. She serves on technical advisory boards for security startups, CloudKnox Security, and ThreatWatch. She is an active speaker at industry and digital innovation events, and has served on the review board for the Grace Hopper and Black Hat conferences.

Growing up in India, Ms. Gupta learned to love math, science, and technology from her dad, an electrical engineer. She is multilingual and holds a master's degree in computer science from San Jose State University and a bachelor's degree in computer engineering from the National Institute of Technology in India. She lives in the San Francisco Bay Area with her husband and son, and you can follow her on Twitter and LinkedIn.



Lea Kissner is the global lead of privacy technology at Google, driven to build respect for users around the world into products and systems. She works with teams across Google and Alphabet to improve the privacy of products, design and build privacy-enhancing infrastructure, and perform novel research into both theoretical and practical aspects of privacy. She has worked at Google for 11 years on projects including logs anonymization, infrastructure security, and privacy infrastructure.

Dr. Kissner is a member of the Advisory Board of the IAPP Privacy Engineering Section and an organizer of the OURSA conference.

She earned a PhD in computer science (with a focus on cryptography) at Carnegie Mellon University and a BS in electrical engineering and computer science from UC Berkeley.



Mike Walker is a principal researcher at Microsoft working on security AI. Before joining Microsoft, he led DARPA's Cyber Grand Challenge, a two-year \$58M contest to construct and compete the first prototypes of reasoning cyberdefense AI. In 2016 at the DEF CON hacking contest, these prototypes took their first flight into the game of hackers, Capture the Flag (CTF), landing zero-day exploits and writing patches in a fully autonomous battle.

Mr. Walker has worked in a policy advisory role, testifying to the President's Commission on Cybersecurity and serving as a contributor and panelist to CSIS's Surviving on a Diet of Poisoned Fruit. Before joining DARPA he worked as a research lab leader and principal vulnerability researcher focusing on tools to amplify vulnerability research abilities with the power of supercomputer automation. He has played in DEF CON CTF finals, coached CTF teams, and built CTFs throughout his career.

He received his BS in computer science from Case Western Reserve University.



Ali Velshi is an anchor and business correspondent for NBC News and MSNBC. He has covered a broad range of breaking news events and global affairs throughout his career, including US presidential elections, ISIL and the Syrian refugee crisis, the Iran nuclear deal from Tehran, the tensions between Russia and NATO from Eastern Europe and the High Arctic, the debt crisis in Greece, the funeral of Nelson Mandela, and the global financial crisis.

Before joining NBC News and MSNBC, he hosted *Ali Velshi On Target*, a nightly primetime show on Al Jazeera America. Before that, he was CNN's chief business correspondent, anchor of CNN International's *World Business Today*, host of CNN's weekly business roundtable *Your Money*, and cohost of CNN's *American Morning*.

An award-winning journalist, Mr. Velshi was honored with a National Headliner Award for Business and Consumer Reporting for "How the Wheels Came Off," a special on the near collapse of the American auto industry. His work on disabled workers and Chicago's red-light camera scandal in 2016 earned him two News and Documentary Emmy Award nominations, adding to a nomination in 2010 for his terrorism coverage. Additionally, he has taken his economic analysis to *Oprah*, *The View*, and *The Daily Show with Jon Stewart*.

Mr. Velshi is the author of *Gimme My Money Back* (Sterling and Ross, 2008) and coauthor, with CNN's Christine Romans, of *How to Speak Money* (Wiley, 2010).

He is a member of the Council on Foreign Relations. Active in the community, he serves on the board of trustees of the Chicago History Museum, and volunteers with New York's Center for Urban Community Services homeless outreach program. Born in Kenya and raised in Canada, Mr. Velshi graduated from Queen's University in Canada, which awarded him an honorary doctorate of laws in 2016.

12:30–1:30 pm

Lunch

West Lawn

12:45–1:30 pm

Testifying Before Congress: A Tutorial

Lecture Room

Lunch buffet served in the East Court



Mr. Christopher King
Executive Director, Office of Congressional and Government Affairs
National Academies of Sciences, Engineering, and Medicine

It is essential that congressional policymakers hear a clear and objective interpretation of what science and technology bring to the policy agenda. This communication is a special type of oral presentation, and several elements are key to its success.

Christopher King is executive director of the National Academies' Office of Congressional and Government Affairs. He was previously acting assistant secretary for Congressional and Intergovernmental Affairs at the US Department of Energy, where he also served as a senior advisor in the Office of Energy Policy and Systems Analysis and director of policy and analysis for the Office of Energy Efficiency and Renewable Energy. Before joining DOE, Mr. King spent over a decade on Capitol Hill, including as the Energy and Environment Subcommittee staff director for the US House Science, Space, and Technology Committee. During his tenure he was chief advisor on DOE matters and involved in a number of successful legislative initiatives, including passage of the America COMPETES Act and establishment of the Advanced Research Projects Agency–Energy (ARPA-E). Mr. King is a graduate of the University of Texas at Austin.

2:00–5:00 pm	Section Meetings NAS Building, 2101 Constitution Avenue NW	
	02 Bioengineering 05 Computer Science 08 Industrial, Manufacturing & Operational Systems 10 Mechanical 11 Earth Resources	Room 125 Board Room Room 280 Lecture Room Room 250
	Keck Center, 500 Fifth Street NW	
	01 Aerospace 03 Chemical 04 Civil 06 Electric Power/Energy Systems 07 Electronics, Communications & Information Systems 09 Materials 12 Special Fields & Interdisciplinary	Room 208 Room 106 Room 100 Room 207 Room 206 Room 101 Room 105
6:30–7:30 pm	Reception	East Ballroom, Mayflower Hotel
7:30–midnight	Dinner and Dancing (black tie optional)	Grand Ballroom, Mayflower Hotel
The Mayflower Hotel is at 1127 Connecticut Avenue NW in downtown Washington. As ever, dance music will be provided by the popular Odyssey Band.		

MEETING SERVICES

- Food Service**

Efforts are made to provide healthy, nutritionally balanced meals at all meetings. If you have special dietary restrictions or any questions about food service, please see Ervin Pinckney in the registration room (NAS 120).
- Information Desk**

The NAE Information Desk is in the Great Hall of the NAS Building. Staff will be available to provide assistance and answer questions about the annual meeting and the NAE membership.
- Logo Items and Rosettes**

NAE logo items are available for purchase at the NAE Store in NAS 118.
- Lost and Found**

Lost and found is located in the registration room (NAS 120).
- Medical Assistance**

For medical assistance go to the Information Desk in the Great Hall of the NAS Building. A registered nurse will be onsite.
- Smoking Policy**

Smoking is not permitted in any building of the National Academies. It is permitted only in designated outdoor areas.

SECTION LEADERSHIP

Section Chairs

Note: Numbers following Section Chairs' names denote primary and secondary NAE section affiliations. Terms end June 30 of year shown.

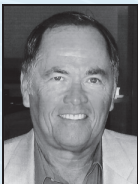

Section 1: Aerospace Engineering
Robert L. Crippen (1)
(Retired President
Thiokol Propulsion)
(2019)



Section 7: Electronics, Communication & Information Systems Engineering
Joe C. Campbell (7)
Professor
Electrical/Computer Engineering Department
University of Virginia
(2019)



Section 2: Bioengineering
James W. Burns (2, 3)
CEO and President
Casebia Therapeutics
(2019)



Section 8: Industrial, Manufacturing & Operational Systems Engineering
Thom J. Hodgson (8)
Distinguished University Professor Emeritus
North Carolina State University
(2020)



Section 3: Chemical Engineering
Ignacio E. Grossmann (3, 8)
Rudolph R. and Florence Dean University
Professor of Chemical Engineering
Carnegie Mellon University
(2019)



Section 9: Materials Engineering
Dawn A. Bonnell (9)
Vice Provost for Research and Professor
University of Pennsylvania
(2019)



Section 4: Civil Engineering
Lisa Alvarez-Cohen (4, 2)
Fred and Claire Sauer Professor of
Civil and Environmental Engineering
Civil and Environmental Engineering Department
University of California, Berkeley
(2019)



Section 10: Mechanical Engineering
Michael Ortiz (10)
Frank and Ora Lee Marble Professor of
Aeronautics and Mechanical Engineering
California Institute of Technology
(2020)

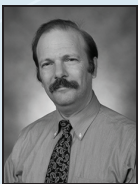

Section 5: Computer Science & Engineering
Moshe Y. Vardi (5)
George Distinguished Service Professor in
Computational Engineering
Rice University
(2019)



Section 11: Earth Resources Engineering
Charles Fairhurst (11, 4)
Senior Consulting Engineer
Itasca Consulting Group, Inc.
(2019)



Section 6: Electric Power/Energy Systems Engineering
Anjan Bose (6, 7)
Regents Professor and Distinguished Professor
of Electric Power Engineering
School of Electrical Engineering and
Computer Science
Washington State University
(2019)



Section 12: Special Fields and Interdisciplinary Engineering
Daniel N. Baker (12, 1)
Director, Laboratory for Atmospheric and Space
Physics
Annenberg Distinguished Visiting Fellow
Hoover Institution
University of Colorado Boulder
(2019)

GUEST PROGRAM

GENERAL INFORMATION

On **Sunday, September 30**, guests are welcome to join NAE members for brunch, followed by the public program—the induction of new members, awards ceremonies, and other presentations—after which they are invited to the reception on the West Lawn.

On the morning of **Monday, October 1**, guests are invited to attend the public forum on **Privacy and Security in the 21st Century – Who Knows and Who Controls?**, or to take a tour of the Kreeger Museum or the Titanic exhibit at the National Geographic Society.

A masterpiece of modernist architecture, the **Kreeger Museum** (kreegermuseum.org) was designed by Philip Johnson in 1963 and completed in 1967. It offers a Monet-filled Great Hall, Terrace Gallery lined with works by Picasso, elegant Sculpture Terrace, and expansive Contemporary Sculpture Garden surrounded by woods. *This docent-led tour will last approximately 1½ hours.*

At the **National Geographic** exhibit ***Titanic: The Untold Story*** (www.nationalgeographic.org/dc/exhibitions/titanic-untold-story), discover the surprising link between a top secret Cold War mission and the 1985 discovery of the Titanic by oceanographer and National Geographic explorer-at-large Robert Ballard. Developed in collaboration with the National Archives and the Ronald Reagan Presidential Library, this exhibition reveals the remarkable—and long-classified—story behind the historic discovery. The exhibit also transports visitors to the height of transatlantic steamship travel, displaying items from the luxurious ocean liner and sharing the stories—many for the first time—of some aboard the ship on its tragic maiden voyage. Among the images and artifacts are the coat worn by Titanic survivor Marion Wright Woolcott, as well as never-before-exhibited ship and expedition memorabilia, including the 8,000-pound crew module from the submersible used to survey the shipwreck. *This program will be approximately 2 hours: a 60-minute video followed by a 45-minute guided tour.*

For both tours: Advance registration is required. Comfortable shoes are recommended for moderate walking and standing. The tours will conclude with a luncheon at the National Press Club.

Also offered is a tour of the **NAS Building** led by Janice Goldblum, National Academies archivist, and Alana Quinn, curator, Cultural Programs of the National Academy of Sciences. The tour will feature and explain the exquisite artistic and architectural details of the Great Hall, the Constitution Avenue foyer and bronze and glass doors, the Members’ Center, Members’ Room, Lecture Room, Board Room, and art exhibitions. Weather permitting, we will also look at the building’s façade.

Please register for this tour in room 120. The program will last approximately 45 minutes and will begin in the West Court at 8:30 am. The forum starts at 9:30 in the Kavli Auditorium and lunch will be provided afterward in the tent on the West Lawn.

Registration Check-In

On Sunday, September 30, and Monday, October 1, meeting registration will be in room 120 at the NAS Building. Please be sure to check in to receive your registration materials.

Registration Hours

Sunday, September 30, 10:00 am–4:00 pm
Monday, October 1, 7:00 am–2:00 pm

Information Desk Hours

Sunday, September 30, 10:30 am–6:30 pm
Monday, October 1, 7:00 am–5:30 pm

NAE Store Hours

Sunday, September 30, 10:00 am–4:00 pm
Monday, October 1, 8:00 am–2:00 pm

IT Help Desk Hours

Sunday, September 30, 10:30 am–5:30 pm
Monday, October 1, 7:30 am–5:30 pm

Shuttle Bus Service

Sunday, September 30

Morning

Departs at 7:15 am
Departs at 10:00 am every 15 minutes, last bus departs at 11:45 am

From	To
------	----

Mayflower	NAS Building
Mayflower	NAS Building

Afternoon

Departs at 2:00 pm every 15 minutes, last bus departs at 2:45 pm

NAS Building	Mayflower
--------------	-----------

Evening

Departs at 5:30 pm, every 15 minutes, last bus departs at 7:30 pm

NAS Building	Mayflower
--------------	-----------

Monday, October 1

Morning

Departs at 6:45 am every 15 minutes, last bus departs at 8:15 am

Mayflower	NAS Building
-----------	--------------

Afternoon

Departs at 1:30 pm and 1:45 pm

NAS Building	Keck Center
--------------	-------------

Evening

Departs at 4:00 pm, every 15 minutes, last bus departs at 6:00 pm
Departs at 4:30 pm, every 15 minutes, last bus departs at 5:30 pm

NAS Building	Mayflower
Keck Center	Mayflower

Guest Tour Bus Service

Monday, October 1

Buses Depart

9:30 am (loads at 9:15 am)
9:30 am (loads at 9:15 am)

From	To
------	----

NAS Building	Kreeger Museum
NAS Building	National Geographic

12:00 noon
12:00 noon

Kreeger Museum	National Press Club
National Geographic	National Press Club

2:00 pm

National Press Club	Mayflower Hotel
---------------------	-----------------

NAS BUILDING MAP

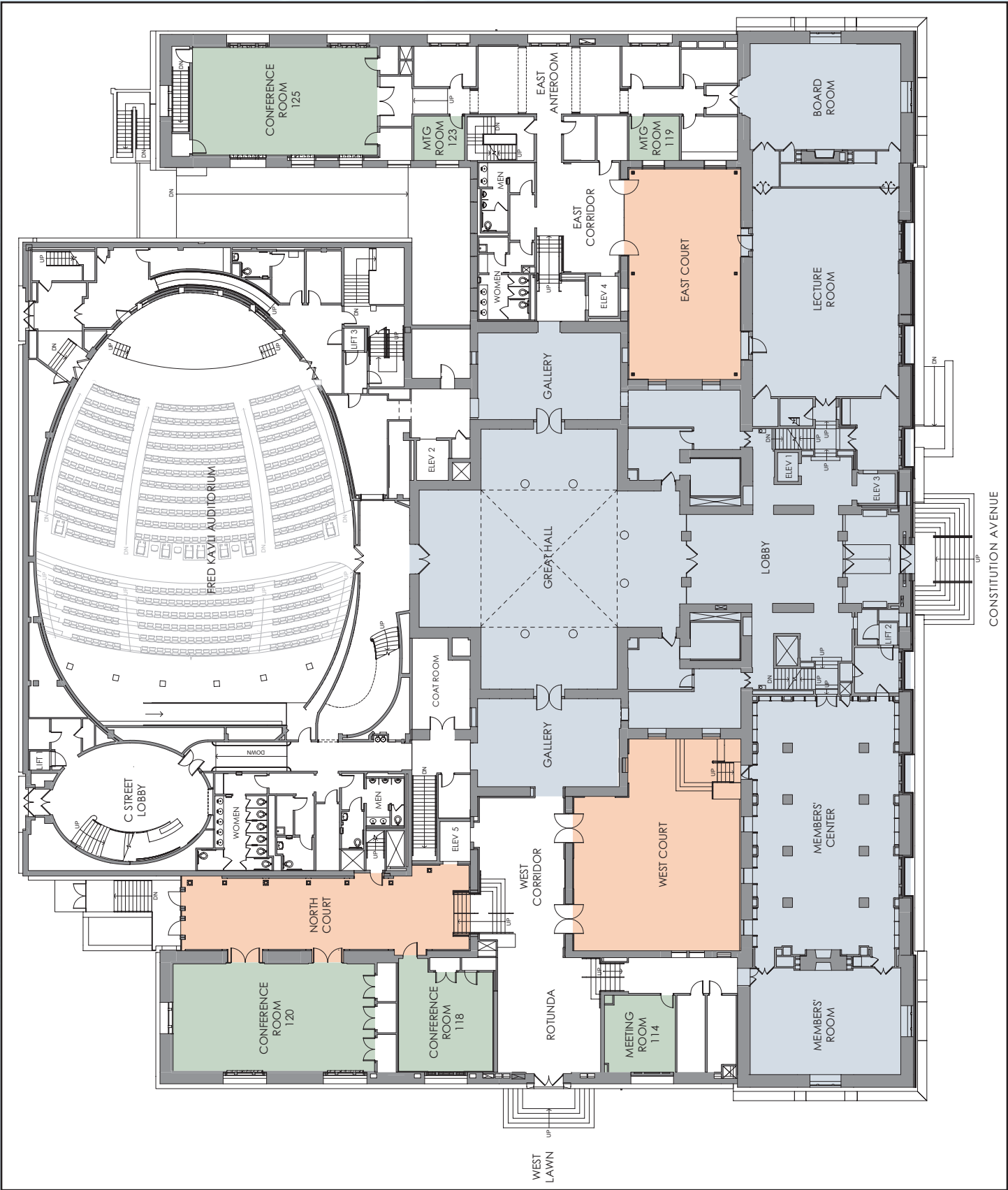

AREA MAP



2017 HONOR ROLL OF DONORS

We greatly appreciate the generosity of our donors. Your contributions enhance the impact of the National Academy of Engineering’s work and support its vital role as advisor to the nation. The NAE acknowledges contributions made as personal gifts or as gifts facilitated by the donor through a donor-advised fund, matching gift program, or family foundation.

EINSTEIN SOCIETY

In recognition of members and friends who have made lifetime contributions of \$100,000 or more to the National Academy of Sciences, National Academy of Engineering, or National Academy of Medicine. Names in bold are NAE members.

\$10 million or more

Arnold and Mabel Beckman* Daniel E. Koshland, Jr.* James H. and Marilyn Simons
Bernard M. Gordon George P. Mitchell*
Fred Kavli* Raymond* and Beverly Sackler

\$5 million to \$9.9 million

Donald L. Bren Fritz J. and Dolores H. Russ Prize Dame Jillian Sackler
William R. and Rosemary B. Fund of the Russ College of
Hewlett* Engineering and Technology at
Peter O’Donnell, Jr. Ohio University

\$1 million to \$4.9 million

Bruce and Betty Alberts Michael and Sheila Held* Richard L. and Hinda G.
Richard and Rita Atkinson Ming and Eva Hsieh Rosenthal*
Norman R. Augustine Irwin and Joan Jacobs Martine A. Rothblatt
Craig and Barbara Barrett Kenneth A. Jonsson* Jack W. and Valerie Rowe
Jordan* and Rhoda Baruch Tillie K. Lubin* Bernard* and Rhoda Sarnat
Stephen D. Bechtel, Jr. John F. McDonnell Leonard D. Schaeffer
Harry E. Bovay, Jr. The Ambrose Monell Foundation Sara Lee and Axel Schupf
Harvey V. Fineberg and Mary E. Gordon and Betty Moore Anthony J. Yun and Kimberly A.
Wilson Philip and Sima Needleman Bazar
Cecil H. Green* Robert* and Mayari Pritzker

\$500,000 to \$999,999

Rose-Marie and Jack R.* Anderson Theodore Geballe Oliver E. and Gerda K. Nelson*
John and Elizabeth Armstrong Penny and Bill George, George Gilbert S. Omenn and Martha A.
Kenneth E. Behring Family Foundation Darling
Gordon Bell William T.* and Catherine Shela and Kumar Patel
Elkan R.* and Gail F. Blout Morrison Golden William J. Rutter
Carson Family Charitable Trust Alexander Hollaender* Herbert A. and Dorothea P.
Charina Endowment Fund Thomas V. Jones* Simon*
Ralph J.* and Carol M. Cicerone Cindy and Jeong Kim Raymond S. Stata
James McConnell Clark Ralph and Claire Landau* Roy and Diana Vagelos
Henry David* Asta and William W. Lang* Andrew and Erna* Viterbi
Richard Evans* Ruben F.* and Donna Mettler Alan M. Voorhees*
Eugene Garfield Foundation Dane* and Mary Louise Miller Anonymous (1)

*Deceased

2017 HONOR ROLL OF DONORS

\$250,000 to \$499,999

The Agouron Institute Robert L. and Anne K. James Stephen* and Anne Ryan
W.O. Baker* Mary and Howard* Kehrl Henry and Susan Samuelli
Warren L. Batts Robin K. and Rose M. McGuire David E. Shaw
Elwyn and Jennifer Berlekamp Janet and Richard M.* Morrow H.E. Simmons*
Clarence S. Coe* Ralph S. O’Connor Judy Swanson
W. Dale and Jeanne C. Compton* Kenneth H. Olsen* Ted Turner
David and Miriam Donoho Ann and Michael Ramage Leslie L. Vadasz
Jerome H.* and Barbara N. Simon Ramo* Martha Vaughan
Grossman Anne and Walt Robb Charles M.* and Rebecca M. Vest
Chad and Ann Holliday Matthew L. Rogers and Swati
William R. Jackson* Mylavarapu

\$100,000 to \$249,999

Holt Ashley* Dotty and Gordon England William I. Koch
Francisco J. and Hana Ayala Emanuel and Peggy Epstein Gail F. Koshland
William F. Ballhaus, Sr.* Olivia and Peter Farrell Jill Howell Kramer
Thomas D.* and Janice H. Barrow Kent Kresa
H.H. and Eleanor F. Barschall* Michiko So* and Lawrence John W. Landis*
Daniel and Frances Berg Tobie and Daniel J.* Fink Janet and Barry Lang
Diane and Norman Bernstein George and Ann Fisher Ming-wai Lau
Bharati and Murty Bhavaraju Robert C.* and Marilyn G. Forney Gerald and Doris Laubach
Chip and Belinda Blankenship Harold K.* and Betty Forsen David M.* and Natalie Lederman
Erich Bloch* William L. and Mary Kay Friend Bonnie Berger and Frank
Barry W. Boehm Christopher Galvin Thomson Leighton
Arindam Bose William H. and Melinda F. Frances and George Ligler
David G. Bradley Gates III Whitney and Betty MacMillan
Lewis M. Branscomb Nan and Chuck Geschke Asad M., Gowhartaj, and Jamal
Daniel Branton Jack and Linda Gill Madni
Sydney Brenner Martin E. and Lucinda Glicksman Davis L. Masten and Christopher
George* and Virginia Bugliarello George and Christine Gloeckler Ireland
Malin Burnham Christa and Detlef Gloge Roger L. McCarthy
Ursula Burns and Lloyd Bean Avram Goldstein* William W. McGuire
John and Assia Cioffi Robert W. Gore Burt and Deedee McMurtry
Paul Citron and Margaret Carlson Paul and Judy Gray G. William* and Ariadna Miller
Citron Corbin Gwaltney Ronald D. Miller
A. James Clark* John O. Hallquist Stanley L. Miller*
G. Wayne Clough Margaret A. Hamburg and Peter F. Sanjit K. and Nandita Mitra
Rosie and Stirling A.* Colgate Brown Joe and Glenna Moore
John D. Corbett* William M. Haney III David* and Lindsay Morgenthaler
Ross and Stephanie Corotis George and Daphne Hatsopoulos Clayton Daniel and Patricia L.
Lance and Susan Davis John L. Hennessy Mote
Roman W. DeSanctis Jane Hirsh Jaya and Venky Narayanamurti
Robert and Florence Deutsch Michael W. Hunkapiller Ellen and Philip Neches
Nicholas M. Donofrio M. Blakeman Ingle Susan and Franklin M. Orr, Jr.
Paul M. Doty* Richard B. Johnston, Jr. David Packard*
Charles W. Duncan, Jr. Anita K. Jones Charles and Doris Pankow*
Ruth and Victor Dzau Trevor O. Jones Larry* and Carol Papay
George and Maggie Eads Thomas Kailath Jack S. Parker*
Robert and Cornelia Eaton Edward E. Penhoet Allen E.* and Marilyn Puckett
James O. Ellis, Jr. and Elisabeth Leon K. and Olga Kirchmayer* Richard F. and Terri W. Rashid
Paté-Cornell Frederick A. Klingenstein

*Deceased

2017 HONOR ROLL OF DONORS

Alexander Rich*
Arthur D. Riggs
Ronald L. Rivest
Henry M. Rowan*
Joseph E. and **Anne P. Rowe***
Jonathan J. Rubinstein
Maxine L. Savitz
Walter Schlup*
Wendy and **Eric Schmidt**
Richard P. Simmons
Robert F. and **Lee S. Sproull**
Georges C. St. Laurent, Jr.

Arnold and Constance **Stancell**
Richard J. and Bobby Ann
 Stegemeier
Edward C. Stone
John and Janet **Swanson**
Charlotte and **Morris Tanenbaum**
Peter and Vivian **Teets**
James M. Tien and Ellen S. Weston
Gary and Diane **Tooker**
James J. Truchard
John C. Wall
Robert and Joan **Wertheim**

Robert M.* and Mavis E. **White**
John C. Whitehead*
Jean D. Wilson
Wm. A. Wulf
Ken Xie
Tachi and Leslie Yamada
Adrian Zaccaria
Alejandro Zaffaroni*
Janet and Jerry Zucker
Anonymous (2)

Listed below are individuals who became members of the Einstein Society between January 1 and August 24, 2018:

Wesley L. Harris
John and Wilma **Kassakian**
R. Noel Longuemare
Narayana and Sudha **Murty**
Julie and **Alton D. Romig, Jr.**

GOLDEN BRIDGE SOCIETY

In recognition of NAE members and friends who have made lifetime contributions totaling \$20,000 to \$99,999. Names in bold are NAE members.

\$75,000 to \$99,999

Kristine L. Bueche
Ruth A. David
Thomas E. Everhart
Robert E. Kahn

Paul and Julie **Kaminski**
Rita Vaughn and **Theodore C.***
 Kennedy
Johanna M.H. Levelt Sengers

Ronald and Joan **Nordgren**

\$50,000 to \$74,999

Jane K. and **William F.**
 Ballhaus, Jr.
Paul F. Boulos
Corbett Caudill
William Cavanaugh
Josephine Cheng
Sunlin Chou
The Crown Family

The Eleftherios Foundation
Paul E. Gray*
Jane and **Norman N. Li**
Darla and **George E.* Mueller**
Jane and **Alan R. Mulally**
Cynthia J. and **Norman A. Nadel**
John Neerhout, Jr.
Robert M. and Marilyn R. **Nerem**

Roberto Padovani
Ellen and **George A.* Roberts**
Warren G. Schlinger*
Leo John* and Joanne **Thomas**
David W. Thompson
Julia and **Johannes Weertman**
Sheila E. Widnall
A. Thomas Young

\$20,000 to \$49,999

Andreas and Juana **Acrivios**
Rodney C. Adkins
Alice Merner Agogino
Clarence R. Allen
Valerie and **William A. Anders**
John and Pat **Anderson**
Seta and **Diran Apelian**
Frances H. Arnold
Ruth and **Ken Arnold**

Kamla* and **Bishnu S. Atal**
Nadine Aubry and John L. **Batton**
Ken Austin
Clyde and Jeanette **Baker**
William F. Banholzer
David K. Barton
Becky and Tom **Bergman**
R. Byron Bird
Diane and **Samuel W. Bodman**

Kathleen and **H. Kent Bowen**
Corale L. Brierley
James A. Brierley
Lenore and **Rob Briskman**
Rodney A. Brooks
Alan C. Brown
Harold Brown
Sigrid and **Vint Cerf**
Selim A. Chacour

*Deceased

2017 HONOR ROLL OF DONORS

Chau-Chyun Chen
Uma Chowdhry
Joseph M. Colucci
Rosemary L. and **Harry M.**
 Conger
Kay and **Gary Cowger**
Natalie W. Crawford
Malcolm R. Currie
David and Susan **Daniel**
Jeffrey Dean
Pablo G. Debenedetti
Mary and **Raymond Decker**
Tom and Bettie **Deen**
Elisabeth M. Drake
E. Linn Draper, Jr.
Mildred S. Dresselhaus*
James J. Duderstadt
Gerard W. Elverum
Stephen N. Finger
Edith M. Flanigen
Samuel C. Florman
G. David Forney, Jr.
Douglas W. and Margaret P.
 Fuerstenau
Elsa M. Garmire and Robert H.
 Russell
Richard L. and Lois E. **Garwin**
Arthur and Helen **Geoffrion**
Louis V. Gerstner, Jr.
Paul H. Gilbert
Eduardo D. Glandt
Arthur L. and Vida F. **Goldstein**
Mary L. Good
Joseph W. Goodman
Albert G. Greenberg
Delon Hampton
Eli Harari
Janina and **Siegfried Hecker**
Robert and Darlene **Hermann**
David and Susan **Hodges**
Edward E. Hood, Jr.
Lee Hood and Valerie Logan
 Hood
Evelyn L. Hu and **David L. Clarke**

J. Stuart Hunter
Ray R. Irani
Edward G.* and Naomi **Jefferson**
George W. Jeffs
Frank and Pam **Joklik**
Min H. Kao
James R.* and Isabelle **Katzer**
Kathryn S. and **Peter S. Kim**
Diana S. and **Michael D. King**
Albert S. and Elizabeth M.
 Kobayashi
Robert M. and Pauline W.
 Koerner
James N. Krebs
Lester C.* and Joan M. **Krogh**
Ellen J. Kullman
Louis J. and M. Yvonne DeWolf
 Lanzerotti
Cato and Cynthia **Laurencin**
Yoon-Woo Lee
Burn-Jeng Lin
Jack E. Little
Thomas* and Caroline **Maddock**
Thomas J. Malone
James F. Mathis
Robert D. Maurer
Dan and Dalia* **Maydan**
James C. McGroddy
Richard A. Meserve
James J. Mikulski
Susan M. and **Richard B. Miles**
James K. and Holly T. **Mitchell**
Duncan T. Moore
Van and Barbara **Mow**
Cherry A. Murray
Matt O'Donnell
Simon Ostrach*
Claire L. Parkinson
Arogyaswami J. Paulraj
Cathy and **Paul S.* Peercy**
Lee and **Bill Perry**
Donald E. Petersen
Julia M. Phillips and John A.
 Connor

Dennis J. Picard
Leonard and Diane Fineblum
 Pinchuk
John W. and Susan M. **Poduska**
Henry H. Rachford, Jr.
Srilatha and **Prabhakar Raghavan**
Joy and **George* Rathmann**
Buddy Ratner and Cheryl **Cromer**
Kenneth and Martha **Reifsnider**
Howie Rosen and Susan **Doherty**
Vinod K. Sahney
Steve* and Kathryn **Sample**
John M. Samuels, Jr.
Jerry Sanders III
Linda S. Sanford
Robert E.* and Mary L. **Schafrik**
Ronald V. Schmidt
Roland W. Schmitt*
Martin B. and Beatrice E. **Sherwin**
Alfred Z. Spector and Rhonda G.
 Kost
David B. and Virginia H. **Spencer**
Henry E. Stone
Gaye and **Alan Taub**
Rosemary and **George**
 Tchobanglous
Daniel M. Tellep
James A. Trainham and Linda D.
 Waters
Raymond Viskanta
Robert and Robyn **Wagoner**
Daniel I. Wang
Albert R.C. and Jeannie
 Westwood
David and Tilly **Whelan**
Willis S. White, Jr.
George M. Whitesides
John J. Wise
Edgar S. Woolard, Jr.
William and Sherry **Young**
Elias A. Zerhouni
Anonymous (1)

Listed below are individuals who became members of the Golden Bridge Society between January 1 and August 24, 2018:

Carl de Boor
Aliene and **Thomas K. Perkins**
Bernard I. Robertson
Katherine K. and **John J. Tracy**
Teresa and **Steve Zinkle**

*Deceased

HERITAGE SOCIETY

In recognition of members and friends who have included the National Academy of Sciences, National Academy of Engineering, or National Academy of Medicine in their estate plans or who have made some other type of planned gift to the Academies. Names in bold are NAE members.

Gene M.* and Marian Amdahl Betsy Ancker-Johnson John C. Angus John and Elizabeth Armstrong Norman R. Augustine Jack D. Barchas Harrison H. and Catherine C. Barrett Stanley Baum Clyde J. Behney Elisabeth Belmont Daniel and Frances Berg Paul Berg Elkan R.* and Gail F. Blout Enriqueta C. Bond Daniel Branton Robert and Lillian Brent Corale L. Brierley James A. Brierley Lenore and Rob Briskman Kristine L. Bueche Dorit Carmelli Peggy and Thomas Caskey A. Ray Chamberlain Linda and Frank Chisari Rita K. Chow John A. Clements D. Walter Cohen Morrel H. Cohen Stanley N. Cohen Colleen Conway-Welch Ross and Stephanie Corotis Ellis and Betsy Cowling Molly Joel Coye Barbara J. Culliton Malcolm R. Currie David and Susan Daniel	Peter N. Devreotes Mildred S. Dresselhaus* Gerard W. Elverum Dotty and Gordon England Emanuel and Peggy Epstein Tobie and Daniel J.* Fink Robert C.* and Marilyn G. Forney William L. and Mary Kay Friend Arthur and Helen Geoffrion Paul H. Gilbert Martin E. and Lucinda Glicksman George and Christine Gloeckler Christa and Detlef Gloge Joseph W. Goodman Chushiro* and Yoshiko Hayashi John G. Hildebrand and Gail D. Burd Nancy S. and Thomas S. Inui Richard B. Johnston, Jr. Anita K. Jones Jerome Kagan Diana S. and Michael D. King Norma M. Lang Daniel P. Loucks R. Duncan* and Carolyn Scheer Luce Thomas* and Caroline Maddock Asad M. and Gowhartaj Madni Pat and Jim McLaughlin Jane Menken Arno G. Motulsky* Van and Barbara Mow Guido Munch Mary O. Munding Philip and Sima Needleman Norman F. Ness Ronald and Joan Nordgren	Gilbert S. Omenn and Martha A. Darling Bradford W. and Virgina W. Parkinson Zack T. Pate Neil and Barbara Pedersen Frank Press James J. Reisa, Jr. Emanuel P. Rivers Richard J. and Bonnie B. Robbins Eugene* and Ruth Roberts James F. Roth Esther and Lewis* Rowland Sheila A. Ryan Paul R. Schimmel Stuart F. Schlossman Rudi* and Sonja Schmid Kenneth I. Shine Robert L. Sinsheimer* Arnold and Constance Stancell H. Eugene Stanley Rosemary A. Stevens John and Janet Swanson Esther Sans Takeuchi Paul and Pamela Talalay Walter Unger John C. Wall Patricia Bray-Ward and David C. Ward Robert and Joan Wertheim Maw-Kuen Wu Wm. A. Wulf Tilahun D. Yilma Michael and Leslee Zubkoff Anonymous (1)
---	---	---

Listed below are individuals who became members of the Heritage Society between January 1 and August 24, 2018:

Julie and **Alton D. Romig, Jr.**

*Deceased

ANNUAL GIVING SOCIETIES

The National Academy of Engineering gratefully acknowledges the following members and friends who made charitable contributions to the NAE, and NAE members who supported the Committee on Human Rights, a joint committee of the three academies, during 2017. The collective, private philanthropy of these individuals has a great impact on the NAE and its ability to be a national voice for engineering.

During the 2016 annual meeting, NAE chair Gordon England announced the creation of a \$100,000 Chairman’s Challenge for Section 1 that he personally funded and asked others to join him in creating matching gift challenges for each section by the 2017 annual meeting. Donors who participated in the Chairman’s Challenge are noted with the # symbol.

Fran Ligler, a member of the NAE Council, and her husband George pledged \$100,000 in 2015 to encourage new and increased giving by Section 2 members for five years or until the \$100,000 goal is reached. Members who participated in the Ligler Challenge are noted with the + symbol.

In response to the Chairman’s Challenge, Paul Boulos gave \$25,000 to fund a challenge for Section 4. Donors who participated in the Section 4 Challenge are noted with the ◊ symbol.

In response to the Chairman’s Challenge, Tom Leighton, Gordon Bell, and Bob Sproull gave \$100,000 to fund a challenge for Section 5. Donors who participated in the Section 5 Challenge are noted with the Ω symbol.

In response to the Chairman’s Challenge, James Truchard gave \$100,000 to fund a challenge for Section 7. Donors who participated in the Section 7 Challenge are noted with the ‡ symbol.

CATALYST SOCIETY

\$50,000+

Chip and Belinda Blankenship Arindam Bose W. Dale and Jeanne C. Compton* Dotty and Gordon England Chad and Ann Holliday	Ming and Eva Hsieh Robin K. and Rose M. McGuire Henry and Susan Samueli† Raymond S. Stata† James J. Truchard	Friend John F. McDonnell
---	--	------------------------------------

ROSETTE SOCIETY

\$25,000 to \$49,999

Paul F. Boulos Nicholas M. Donofrio† James O. Ellis, Jr. and Elisabeth Paté-Cornell John O. Hallquist	Bonnie Berger and Frank Thomson Leighton Clayton Daniel and Patricia L. Mote Richard F. and Terri W. Rashid	David E. Shaw Richard P. Simmons Robert F. and Lee S. Sproull
--	---	---

CHALLENGE SOCIETY

\$10,000 to \$24,999

John and Elizabeth ArmstrongΩ Frances H. Arnold† Gordon Bell Elwyn and Jennifer BerlekampΩ Barry W. BoehmΩ Chau-Chyun Chen Josephine Cheng Sunlin Chou† Ross and Stephanie Corotis◊	Ruth A. David Lance and Susan Davis Olivia and Peter Farrell† Martin E. and Lucinda Glicksman Paul and Judy Gray Michael W. Hunkapiller J. Stuart Hunter John and Wilma Kassakian Kent Kresa#	Ellen J. Kullman Frances and George Ligler Narayana and Sudha MurtyΩ Jaya and Venky Narayanamurti† Ronald and Joan Nordgren Larry* and Carol Papay Arogyaswami J. Paulraj Estate of Charles Eli Reed Ronald L. Rivest
---	---	---

Chairman’s Challenge
† Ligler Challenge
◊ Section 4 Challenge

Ω Section 5 Challenge
‡ Section 7 Challenge
*Deceased

2017 HONOR ROLL OF DONORS

Julie and Alton D. Romig, Jr.[#]
John M. Samuels, Jr.
Robert E.* and Mary L. Schafrik
Wendy and Eric Schmidt^Ω

CHARTER SOCIETY

\$1,000 to \$9,999

Linda M. Abriola
Andreas and Juana Acrivos
Ilesanmi Adesida
Rodney C. Adkins
Ronald J. Adrian
Kyle T. Alfriend
Montgomery and Ann Alger
John and Pat Anderson
Alfredo H. Ang
John C. Angus
Frank F. Aplan
Ruth and Ken Arnold
R. Lyndon Arscott
Aziz I. Asphahani
Ken Austin
Wanda M. and Wade Austin
Amos A. Avidan
Arthur B. Baggeroer
Clyde and Jeanette Baker[◇]
William F. Baker
Tamer Basar
Steven Battel
Craig and Karen Benson
Daniel and Frances Berg
Neal S. Bergano[‡]
Becky and Tom Bergman
Bharati and Murty Bhavaraju
Mark and Kathy Board
Diane and Samuel W. Bodman
Mark T. Bohr
Rudolph Bonaparte
Lillian C. Borrone[◇]
Kathleen and H. Kent Bowen
Craig T. Bowman
Frank Bowman
Lewis M. Branscomb
Corale L. Brierley
James A. Brierley
Lenore and Rob Briskman[‡]
Andrei Z. Broder^Ω
Alan C. Brown[‡]
John H. Bruning
George* and Virginia Bugliarello[◇]
Jim and Ellen Burns

Richard J. Stegemeier
David W. Thompson
Adrian Zaccaria

Antonio J. Busalacchi, Jr.
Wesley G. Bush[‡]
François J. Castaing
Corbett Caudill[#]
Gerbrand and Kristin Ceder
Selim A. Chacour
Don B. Chaffin
Dianne Chong
Uma Chowdhry
James J. Coleman
Joseph M. Colucci
Rosemary L. and Harry M. Conger
Stuart L. Cooper[‡]
Richard W. Couch, Jr.
Kay and Gary Cowger
Natalie W. Crawford[#]
Robert L. Crippen
James W. Dally
David and Susan Daniel
L. Berkley Davis
Pablo G. Debenedetti
Mary and Raymond Decker
Thomas F. and Anne R. Degnan
George E. Dieter
Frederick H. Dill
Stephen W. Director
Ali H. Dogru
Fiona M. Doyle
Elisabeth M. Drake
Eric H. Ducharme[#]
James J. Duderstadt
Susan T. Dumais
Robert and Cornelia Eaton
Derek Elsworth
Gerard W. Elverum
John V. Evans[‡]
Robert R. Everett
Thomas E. Everhart
Hans K. Fauske
Robert E. Fenton
Leroy M. Fingerson
Bruce A. Finlayson
Anthony E. Fiorato
Edith M. Flanigen

Friend
Cathy Peercy

Samuel C. Florman
Maria Flytzani-Stephanopoulos
G. David Forney, Jr.
Robert C.* and Marilyn G. Forney
Heather and Gordon Forward
Katharine G. Frase
William L. and Mary Kay Friend
Douglas W. and Margaret P.
Fuerstenau
Huajian Gao
Elsa M. Garmire and Robert H.
Russell
Donald P. Gaver
Ronald L. Geer
Arthur Gelb[#]
Arthur and Helen Geoffrion
Louis V. Gerstner, Jr.
Nan and Chuck Geschke^Ω
Paul H. Gilbert
Bernd Girod
Eduardo D. Glandt
Earnest F. Gloyna
Dan M. Goebel
Arthur L. and Vida F. Goldstein
Mary L. Good
Joseph W. Goodman[‡]
W. David Goodyear[◇]
Albert G. Greenberg
Helen Greiner
Gary S. Grest
Hermann K. Gummel[‡]
Eliyahou Harari
James S. Harris, Jr.
Wesley L. Harris[#]
William A. Hawkins III[‡]
Janina and Siegfried Hecker
Chris T. Hendrickson
John L. Hennessy^Ω
Arthur H. Heuer and Joan Hulburt
Urs Höelzle
Edward E. Hood, Jr.[#]
Lee Hood and Valerie Logan
Hood
John R. Howell

Chairman's Challenge
‡ Ligler Challenge
◇ Section 4 Challenge

Ω Section 5 Challenge
‡ Section 7 Challenge
*Deceased

2017 HONOR ROLL OF DONORS

Evelyn L. Hu and David R. Clarke
Mir A. Imran[‡]
Ray R. Irani
Mary Jane Irwin
Irwin and Joan Jacobs
Wilhelmina and Stephen Jaffe
Leah H. Jamieson
George W. Jeffs
James O. Jirsa
Barry C. Johnson
David W. Johnson, Jr.
Kristina M. Johnson[‡]
Michael R. Johnson[◇]
Frank and Pam Joklik
Kahle/Austin Foundation
Robert E. Kahn
Eric W. and Karen F. Kaler
Paul and Julie Kaminski
Melvin F. Kanninen
James R.* and Isabelle Katzer
Michael C. Kavanaugh
Leon M. Keer
Mary and Howard* Kehrl
Chaitan Khosla and Susi Ebert-
Khosla
Diana S. and Michael D. King
James L. Kirtley
Gary J. and Susan S. Klein
Albert S. and Elizabeth M.
Kobayashi
Paul C. Kocher
Robert M. and Pauline W.
Koerner[◇]
Charles E. Kolb, Jr.
Jindrich Kopecek
Demetrious Koutsoftas
Philip T. Krein
Fikri J. Kuchuk
Derrick M. Kuzak
Louis J. and M. Yvonne DeWolf
Lanzerotti
David C. Larbalestier
Ronald K. Leonard
Frederick J. Leonberger[‡]
Burn-Jeng Lin
Steven B. Lipner
Helmut List
Jack E. Little
John D.C. Little
Robert G. Loewy[#]
Daniel P. Loucks
Lester L. Lyles
Thomas* and Caroline Maddock

Arunava Majumdar
Henrique S. Malvar
Hans Mark[#]
David A. Markle
W. Allen Marr
John L. Mason
Jyotirmoy Mazumder
Larry V. McIntire
Kishor C. Mehta[◇]
Edward W. Merrill
Richard A. Meserve
Robert M. Metcalfe
R.K. Michel
Susan M. and Richard B. Miles
Richard K. and Beth Miller
James K. and Holly T. Mitchell
Duncan T. Moore
Charles W. Moorman[◇]
William B. Morgan
Edward and Stephanie Moses
Richard S. Muller[‡]
Cherry A. Murray
Cynthia J. and Norman A. Nadel
Albert Narath
John Neerhout, Jr.
Robert M. and Marilyn R. Nerem
Paul and Dotty Nielsen[‡]
Matt O'Donnell
Fran and Kwadwo Osseo-Asare
Julio M. Ottino
Roberto Padovani[‡]
Sorab Panday
Morton B. Panish
Claire L. Parkinson
P. Hunter Peckham
Celestino R. Pennoni[◇]
John H. Perepezko
Thomas K. Perkins
William J. Perry
Kurt E. Petersen
Julia M. Phillips and John A.
Connor
Leonard and Diane Fineblum
Pinchuk
James D. Plummer
Victor L. Poirier
Chris and Barbara Poland
Stephen M. Pollock
H. Vincent Poor
Dana A. Powers
William F. Powers
William R. Pulleyblank
Henry H. Rachford, Jr.

Srilatha and Prabhakar Raghavan^Ω
Vivian and Subbiah Ramalingam
Doraiswami Ramkrishna
Buddy Ratner and Cheryl Cromer
Wanda K. Reder
Kenneth and Martha Reifsnider
Gintaras V. Reklaitis
Eli Reshotko
Thomas J. Richardson[‡]
Richard J. and Bonnie B. Robbins
Bernard I. Robertson
C. Paul Robinson
Thomas E. Romesser
Murray W. Rosenthal
Vinod K. Sahney
Ann B. Salamone
Joseph C. Salamone
Jerry Sanders III
Linda S. Sanford
Maxine L. Savitz
Richard Scherrer
Jan C. Schilling
John H. Schmertmann[◇]
Geert W. Schmid-Schoenbein
Ronald V. Schmidt[‡]
Henry G. Schwartz, Jr.[◇]
Lyle H. Schwartz
Norman R. Scott
Nambirajan Seshadri
Martin B. and Beatrice E. Sherwin
Neil G. Siegel
Daniel P. Siewiorek
Debra and Alexander Slocum
Alvy Ray Smith
Alfred Z. Spector and Rhonda G.
Kost
David B. and Virginia H. Spencer
Gunter Stein[‡]
Dean E. Stephan
Gregory Stephanopoulos
William D. Strecker
Ronald D. Sugar
Virginia and Carl Sulzberger
John and Janet Swanson
Richard M. Swanson[‡]
Gaye and Alan Taub
Peter and Vivian Teets[#]
Edwin L. Thomas
James M. Tien and Ellen S. Weston
Matthew V. Tirrell
Richard L. Tomasetti[◇]
Gary and Diane Tooker
Henrik Topsøe

Chairman's Challenge
‡ Ligler Challenge
◇ Section 4 Challenge

Ω Section 5 Challenge
‡ Section 7 Challenge
*Deceased

2017 HONOR ROLL OF DONORS

Gavin P. Towler
James A. Trainham and Linda D. Waters
John R. Treichler[‡]
Richard H. Truly[‡]
Robert C. Turnbull
A. Galip Ulsoy
David M. Van Wie
Charles M.* and Rebecca M. Vest
Andrew and Erna* Viterbi[‡]
Thomas H. Vonder Haar
Robert and Robyn Wagoner
John C. Wall
David Walt and Michele May
Kuo K. Wang
John E. Warnock^Ω
Darsh T. Wasan
Warren and Mary Washington
Sheldon Weinig
David and Tilly Whelan[‡]

Robert M.* and Mavis E. White
Willis S. White, Jr.
Ward O. Winer
Sharon L. Wood
Dennis A. Woodford
Edgar S. Woolard, Jr.
Richard N. Wright^Ω
Israel J. Wygnanski
Beverly and Loring Wyllie
KeChang Xie
Henry T.Y. Yang[‡]
David D. Yao
Michael I. Yarymovych[‡]
William W-G. Yeh^Ω
Paul G. Yock
Yannis C. Yortsos
William and Sherry Young
Zarem Foundation
Elias A. Zerhouni
Teresa and Steve Zinkle

Ben T. Zinn
Mary Lou and Mark D. Zoback
Stacey I. Zones
Charles F. Zukoski
Anonymous (1)

Friends

Rose-Marie and Jack R.* Anderson
Josephine F. Berg
Kristine L. Bueche
Janet Frane
Marjorie R. Friedlander
Jim and Cindy Hinchman
Evelyn S. Jones
Edmund and Laura Leopold
Sara McComb and Abhi Deshmukh
Toby Wolf

OTHER INDIVIDUAL DONORS

H. Norman Abramson[‡]
Hadi Abu-Akeel
Mihran S. Agbabian^Ω
William G. Agnew
Kevin Anderson
George E. Apostolakis
Ali S. Argon
Daniel and Monica Atkins
Teresa and Harry Atwater
Donald W. Bahr
Grigory I. Barenblatt
James E. Barger
Jordan* and Rhoda Baruch
Ray H. Baughman
Zdenek P. Bazant
Marlene and Georges Belfort
Marsha J. Berger
Toby Berger[‡]
Philip A. Bernstein^Ω
Peter J. Bethell
Madan M. Bhasin
John R. and Pierrette G. Birge
Ilan Asriel Blech
Jack L. Blumenthal
Alfred Blumstein
F. Peter Boer
William J. Boettinger
James P. Brill
Emery N. Brown
Harold Brown

Howard J. Bruschi
Jack E. Buffington
Anne and John* Cahn
A. Robert Calderbank[‡]
James D. Callen
Federico Capasso
Max W. Carbon
E. Dean Carlson^Ω
A. Ray Chamberlain
Morris Chang[‡]
Douglas M. Chapin
Vernon L. Chartier
Young-Kai Chen[‡]
Shu Chien
Andrew R. Chraplyvy[‡]
John L. Cleasby^Ω
Morton Collins
Jingsheng J. Cong^Ω
Richard A. Conway^Ω
Arthur J. Coury[‡]
Alan W. Cramb
Ernest L. Daman
Ingrid Daubechies^Ω
Tom and Bettie Deen
Joseph M. DeSimone
Daniel W. Dobberpuhl^Ω
Robert H. Dodds^Ω
Irwin Dorros[‡]
Earl H. Dowell[‡]
E. Linn Draper, Jr.

T. Dixon Dudderar
David A. Dzombak^Ω
Peter S. Eagleson
Lewis S. Edelheit[‡]
Bruce R. Ellingwood
Richard E. Emmert
Joel S. Engel[‡]
Lawrence B. Evans
S.M. Farouq Ali
Millard and Barbara Firebaugh
Robert E. Fontana[‡]
Harold K.* and Betty A. Forsen
Judson C. French
L.B. Freund
Eli Fromm
Theodore V. Galambos^Ω
Zvi Galil^Ω
C. William Gear^Ω
Jacqueline Gish
Richard J. Goldstein
John B. Goodenough
David J. Goodman
Roy W. Gould
Paul E. Gray^{**}
Irene Greif
Ignacio E. Grossmann
Donald J. Haderle^Ω
Edward E. Hagenlocker
Carol K. Hall
Paula T. Hammond

Chairman’s Challenge
† Ligler Challenge
Ω Section 4 Challenge

Ω Section 5 Challenge
‡ Section 7 Challenge
*Deceased

2017 HONOR ROLL OF DONORS

Mehdi Hatamian[‡]
Adam Heller
Martin Hellman[‡]
Robert and Paula Henry
Keith W. Hipel
George J. Hirasaki
Peter B. Hirsch
John P. Hirth
David[‡] and Susan Hodges
Davorin D. Hrovat
James E. Hubbard[‡]
John R. Huff
Thomas J.R. Hughes
Salim M. Ibrahim
Izzat M. Idriss^Ω
Jeremy Isenberg
Akira Ishimaru
Tatsuo Itoh[‡]
Andrew Jackson and Lillian Rankel
Linos J. Jacovides
Anil K. Jain^Ω
Paul C. Jennings
Donald L. Johnson
Keith P. and Cheryl A. Johnston
Anita K. Jones
Marshall G. Jones
Trevor O. Jones[‡]
Chanrashekhar Joshi
Norman P. Jouppi^Ω
Ahsan Kareem
Kristina B. Katsaros
Pradman P. Kaul[‡]
Kenneth H. Keller
Marilyn and Justin Kerwin
Noboru Kikuchi
Timothy L. Killeen
Sung Wan Kim
Robert L. Kleinberg
Bernard L. Koff[‡]
Bill and Ann Koros
John J. Koszewnik
Roger B. and Barbara Nunn Krieger
Mark H. Kryder[‡]
Thomas F. Kuech
Bruce M. Lake
David A. Landgrebe
Enrique J. Lavernia
Edward D. Lazowska^Ω
Sidney Leibovich
Margaret A. LeMone
Johanna M.H. Levelt Sengers

Peter W. Likins
Yu-Kweng M. Lin^Ω
Kuo-Nan Liou
Nathan and Barbara Liskov
Andrew J. Lovinger
William R. Lucas[‡]
Cecil Lue-Hing
Mark[‡] and Mary Lundstrom
Verne L. Lynn[‡]
John W. Lyons
J. Ross Macdonald[‡]
Alfred U. MacRae[‡]
Jon D. Magnusson^Ω
Subhash and Sushma Mahajan
William F. Marcuson III^Ω
Robert C. Marini^Ω
James J. Markowsky
Jacob H. Masliyah
David K. Matlock
Fujio Matsuda
Robert D. Maurer
William C. Maurer
Robert and Norah McMeeking
Terence P. McNulty
Antonios G. Mikos
James A. Miller
Warren F. Miller, Jr.
Piotr D. Moncarz
Carl L. Monismith
John R. Monnier
A. Stephen Morse
George Muellner
Jane and Alan R. Mulally[‡]
Earll M. Murman[‡]
Devaraysamudram R. Nagaraj
R. Shankar Nair^Ω
David Nash
Alan Needleman
Stuart O. Nelson
Arkadi S. Nemirovski
Joseph H. Newman
William D. Nix
Karl H. Norris
Babatunde and Anna Ogunnaike
Elaine S. Oran
Athanassios Z. Panagiotopoulos
Stavros S. Papadopoulos
Donald R. Paul
Harold W. Paxton
Nicholas A. Peppas
George M. Pharr
William P. Pierskalla
Mark R. Pinto

Karl S. Pister^Ω
John W.^Ω and Susan M. Poduska
Stephen and Linda Pope
Harry G. Poulos^Ω
Michael Prats
Ronald F. Probstein
Charles W. Pryor, Jr.
Roberta and Edwin Przybylowicz
Robert A. Pucel
Rajagopal S. Raghavan
Kaushik Rajashekara
Ekkehard Ramm
Robert A. Rapp
L. Rafael Reif
John R. Rice
Bruce E. Rittmann
Jerome G. Rivard
Leslie E. Robertson^Ω and SawTeen See
Virginia M. Rometty
Arye Rosen[‡]
Howie Rosen and Susan Doherty
Kenneth M. Rosen
Hans T. Rossby
William B. Rouse
Eli Ruckenstein
B. Don and Becky Russell
Peter W. Sauer
Robert F. Sawyer
George W. Scherer
Fred B. Schneider and Mimi Bussan
Jerald L. Schnoor
William R. Schowalter
Walter J. Schrenk
Albert and Susan Schultz[‡]
Mischa Schwartz[‡]
David L. Sedlak^Ω
Bal Raj Sehgal
Robert J. Serafin
F. Stan Settles
Surendra P. Shah^Ω
Don W. Shaw
Ben A. Shneiderman
Michael L. Shuler
Arnold H. Silver
Jack M. Sipress
R. Wayne Skaggs
Sarah Slaughter^Ω
Stuart L. Soled
Soroosh Sorooshian
Pol D. Spanos
Edgar A. Starke, Jr.

Chairman’s Challenge
† Ligler Challenge
Ω Section 4 Challenge

Ω Section 5 Challenge
‡ Section 7 Challenge
*Deceased

George L. Stegemeier
Robert L. Steigerwald
George Stephanopoulos
Howard and Valerie Stone
Richard G. Strauch
Gerald B. Stringfellow
Stanley C. Suboleski
Yasuharu Suematsu†
Kathryn D. Sullivan
Yongkui Sun
James M. Symons◊
Rodney J. Tabaczynski
Eva Tardos
Daniel M. Tellep
Lewis M. Terman
Leonard K. Thomas
Neil E. Todreas
Mehmet Toner†
Alvin Trivelpiece
John M. Undrill
Theodore Van Duzer
Suzanne M. Vautrinot
Harold J. Vinegar
Irving T. Waaland‡
Wallace R. Wade
Steven J. WallachΩ
John D. Warner‡
Michael S. WatermanΩ
John T. and Diane M. Watson
Robert J. Weimer
Sheldon Weinbaum†
Chris and Fran Whipple
Robert M. White
J. Turner Whitted
Janusz S. Wilczynski‡
Alan E. Willner‡
Richard David Woods◊
David A. Woolhiser
Wm. A. Wulf
Eli Yablonovitch
Ajit P. Yoganathan

Les Youd
Laurence R. Young
Paul Zia
Anonymous (1)

Friends
Martha J. Bamby
Charles Barlowe
Tom Barnes and Diane Rittmueller
Leslie Bowers
Alan Brailsford
Sydney Busch
Susan and Hugh Catts
Raymond and Lila Cohen
Ron and Patty Coolbaugh
Craig and Lori Davis
Betty Dyer
Robert and Judith Eagan
Evelyn Earlougher
Clara K. Ellert
Frances P. Elliott
Frederick Erickson
James D. Ettari
Harold and Arlene Finger
Joan R. Finnie
Catherine Fowler
David Frane and Charla Gabert
Julia E. Frane
Peter Frane
Harold Frost III
Kimberly F. Garcia
Jenny and Michael Gilbert
Sharon P. Gross
Katherine M. Haffner
Edith Hampton
Crystal Harris
Sara Hart and Abe Middleton
Marilyn Heebner
Leslie Henderson
Robert Hetrick
Jodie L. Janowiak

Roger and Dolores Kiel
Jamie M. Killorin
Estella Kohler
Joan Kripke
Ethel Lagos
Sally F. H. Levinson
Lois B. MacPherson-McCready
Steven E. Mansbach
Michael Mariottini
Barbara Mason
Gymme O. Miele
Michele H. Miller
Joanne Morse
Michael Murphy and Karen Gundersen
Radka Z. Nebesky
Shawn Neil
Kristina Novick
Andrew Oakley
Colm and Kumi O’Cinneide
Sallie O’Neill
Gail Prete
Gayle Prete
Angela Puertas
Bryan Quigley
Cecilia Schlesinger
John and Elizabeth Schneider
John Schwartzman
Leroy Schwartzman
Janet Shanks
Edward Sickafus
Verna W. Spinrad
Elizabeth W. Toor
Marianne Tropp and Chris Loughner
Robert Truitt
Kelly Tufts
Reha Uzsoy
Maureen Ward
Rhoda A.M. Weisz
Earnesto Williams

Chairman’s Challenge
† Ligler Challenge
◊ Section 4 Challenge

Ω Section 5 Challenge
‡ Section 7 Challenge
*Deceased

TRIBUTES

In Memory of Jordan Baruch – Rhoda Baruch
In Memory of Robert R. Berg – Josephine F. Berg
In Memory of Gary L. Borman – Roger B. and Barbara Nunn Krieger
In Memory of Arthur Bueche – Kristine L. Bueche
In Memory of George Bugliarello – Virginia Bugliarello
In Memory of W. Dale and Jeanne C. Compton – Martha J. Bamby, Charles Barlowe, Tom Barnes and Diane Rittmueller, Alan Brailsford, Susan and Hugh Catts, Raymond and Lila Cohen, Ron and Patty Coolbaugh, Craig and Lori Davis, David Frane and Charla Gabert, Julia E. Frane, Peter Frane, Kimberly F. Garcia, Jenny and Michael Gilbert, Katherine M. Haffner, Sara Hart and Abe Middleton, Leslie Henderson, Robert Hetrick, Joan Kripke, Edmund and Laura Leopold, Mark and Mary Lundstrom, Lois B. MacPherson-McCready, Steven E. Mansbach, Michael Mariottini, Sara McComb and Abhi Deshmukh, Colm and Kumi O’Cinneide, Gail Prete, Gayle Prete, Maxine L. Savitz, John and Elizabeth Schneider, Edward Sickafus, Robert Truitt, Kelly Tufts, Reha Uzsoy, Henry T.Y. Yang
In Memory of Robert Earlougher – Evelyn Earlougher
In Memory of Harry and Norma Fineblum – Leonard Pinchuk
In Memory of Harold K. Forsen – Betty A. Forsen
In Memory of Sheldon K. Friedlander – Marjorie R. Friedlander
In Memory of Maurice Fuerstenau – Douglas W. and Margaret P. Fuerstenau
In Memory of Thomas L. Hampton – Leslie Bowers, Janet Shanks
In Memory of John M. Hanson – Gary J. and Susan S. Klein
In Memory of Howard S. Jones, Jr. – Evelyn S. Jones
In Memory of Max A. Kohler – Estella Kohler, Ethel Lagos, John Schwartzman, Leroy Schwartzman
In Memory of T. William Lambe – W. Allen Marr
In Memory of Karen Larbalestier – David C. Larbalestier
In Memory of William H. Lin – Burn-Jeng Lin
In Memory of Edward A. Mason – Barbara Mason
In Memory of Eric Muntz – Cecilia Schlesinger
In Memory of Wesley L. Nyborg – Harold Frost III
In Memory of Simon Ostrach – Angela Puertas
In Memory of Paul S. Peercy – Cathy Peercy
In Memory of Ernest Smerdon – Soroosh Sorooshian
In Memory of Chang-Lin Tien – Arunava Majumdar
In Memory of Chuck Vest – Jyotirmoy Mazumder, John W. and Susan M. Poduska, Stephen M. Pollock
In Memory of Harvey A. Wagner – Arthur and Helen Geoffrion
In Memory of Jack K. Wolf – Toby Wolf
In Honor of Jean Jouppi – Norman P. Jouppi
In Honor of Eliza Kuchuk – Fikri J. Kuchuk
In Honor of Clayton Daniel and Patricia L. Mote – Joan R. Finnie
In Honor of Lisa O’Donnell – Maureen Ward
In Honor of Julie and Alton D. Romig, Jr. – Robert and Judith Eagan
In Honor of Henry E. Stone – Howard and Valerie Stone
In Honor of President Donald Trump – Kristina Novick
In Honor of Chris Weber and our future Engineer Girl – Sydney Busch

THE LOYALTY SOCIETY

Recognizes members and friends who have made gifts to the National Academy of Sciences, National Academy of Engineering, or National Academy of Medicine for at least 20 years. Names in bold are NAE members.

Francois M. Abboud
H. Norman Abramson
Andreas and Juana **Acrivros**
Bruce and Betty Alberts

Clarence R. Allen
Marilynn and **Charles A.* Amann**
Waytt W. Anderson
John C. Angus

Frank F. Aplan
Edward M. Arnett
Daniel L. Azarnoff
Donald W. Bahr

*Deceased

2017 HONOR ROLL OF DONORS

Jack D. Barchas
Jeremiah A. Barondess
Howard L. Bailit
Stephen D. Bechtel, Jr.
Richard E. Behrman
Gordon Bell
Leslie Z. Benet
Paul Berg
Kenneth I. Berns
Diane and Norman Bernstein
Stuart Bondurant and Susan Ehringhaus
Marie McCormick and Robert Blendon
Kathleen and **H. Kent Bowen**
Lewis M. Branscomb
John and Sharon Brauman
W.F. Brinkman
Alan C. Brown
Donald D. Brown
Harold Brown
Kristine L. Bueche
Jack E. Buffington
George* and Virginia **Bugliarello**
William B. Carey
David R. and Jacklyn A. Challoner
Purnell W. Choppin
James McConnell Clark
Eugenio Calabi
John L. Cleasby
John A. Clements
Linda Hawes Clever
Michael D. Coe
Richard A. Conway
Max D. Cooper
Linda A. Cozzarelli
Pedro M. Cuatrecasas
Lawrence B. Curtis*
William H. Danforth
Igor B. Dawid
Mary and **Raymond Decker**
Roman W. DeSanctis
Nicholas M. Donofrio
Irwin Dorros
W.G. Ernst
Harold J. Fallon
Gary Felsenfeld
Harvey V. Fineberg and Mary E. Wilson
Tobie and **Daniel J.* Fink**
Samuel C. Florman
G. David Forney, Jr.
Robert C.* and Marilyn G. **Forney**
Harold K.* and Betty **Forsen**

T. Kenneth Fowler
Hans and Verena Frauenfeld
Carl Frieden
Theodore V. Galambos
Joseph G. Gall
Ronald L. Geer
E. Peter Geiduschek
Nan and **Chuck Geschke**
David V. Goeddel
Mary L. Good
Joseph W. Goodman
Richard M. Goody
Ronald L. Graham
Paul E. Gray*
Shirley and Harry Gray
Robert B. Griffiths
Michael Grossman
Adam Heller
Jane E. Henney and Robert Graham
Ernest M. Henley*
David and Susan **Hodges**
Frank Hole
Edward E. Hood, Jr.
Joseph F. Hoffman
William N. Hubbard, Jr.
Catherine Adams Hutt and Peter Barton Hutt
André T. Jagendorf*
Robert L. and Anne K. James
George W. Jeffs
Paul C. Jennings
James O. Jirsa
Anita K. Jones
Richard V. Kadison
Samuel L. Katz and Catherine M. Wilfert
Max A. Kohler*
James S. and Elinor G.A. Langer
Louis J. and M. Yvonne DeWolf
Lanzerotti
Lynn M. Larsen
Joyce C. Lashof
Gerald and Doris **Laubach**
Judith R. Lave
Cynthia and Robert Lawrence
Johanna M.H. Levelt Sengers
Robert G. Loewy
Thomas* and Caroline **Maddock**
Anthony P. Mahowald
Vincent T. Marchesi
Hans Mark
James F. Mathis
Robert D. Maurer

*Deceased

2017 HONOR ROLL OF DONORS

Alvin Trivelpiece
Roxanne and Karl K.* Turekian
Martha Vaughan
Raymond Viskanta
Andrew and Erna* **Viterbi**
Peter K. Vogt
Irv Waaland

George D. Watkins
Johannes and **Julia Weertman**
Robert J. Weimer
Herbert Weissbach
Jasper A. Welch, Jr.
Robert M.* and Mavis E. **White**
Catherine M. Wilfert

Evelyn M. Witkin
Owen N. Witte
Gerald N. Wogan
Wm. A. Wulf
Anonymous (1)

FOUNDATIONS, CORPORATIONS, AND OTHER ORGANIZATIONS

In recognition of foundations, corporations, or other organizations that made gifts or grants to support the National Academy of Engineering in 2017.

Amgen Foundation
Avid Solutions Industrial Process Control
Bell Family Foundation
Benevity Community Impact Fund
Bodman Family Foundation
The Boeing Company
Boeing PAC Match Program
Boer Family Foundation, Inc.
Branscomb Family Foundation
Castaing Family Foundation
Chevron Corporation
Chevron Matching Employee Funds
Combined Jewish Philanthropies
Cummins, Inc.
Dassault Systèmes
Duke Energy Corporation
Fidelity Charitable Gift Fund
Ford Motor Company
Forney Family Foundation
GE Aviation
General Electric Foundation
Goldman Sachs Philanthropy Fund
Gratis Foundation
Honeywell International Charity Matching
Houston Jewish Community Foundation
Hsieh Family Foundation
Huff Family Foundation
Innovative Catalytic Solutions
Intrigal, Inc.
Jewish Community Foundation San Diego
W.M. Keck Foundation
Microsoft Corporation
The Gordon and Betty Moore Foundation
Morgan Stanley
Morgan Stanley Smith Barney Global Impact Funding Trust, Inc.

National Christian Foundation
Network for Good
Northrop Grumman Foundation
Ohio University Foundation
Olin College of Engineering
Oracle Corporation
Payden & Rygel
Pennoni Family Foundation
PJM Interconnection
Qualcomm, Inc.
Henry M. Rowan Family Foundation, Inc.
B. Don and Becky Russell Charitable Foundation
Saint Louis Community Foundation
Samueli Foundation
The Charles Schwab Corporation
Schwab Charitable Fund
Henry & Sally Schwartz Family Foundation
The Seattle Foundation
Shell Oil Company
Siegel & Family Foundation
Silicon Valley Community Foundation
The Ronald and Valerie Sugar Family Foundation
T. Rowe Price Program for Charitable Giving
TE Connectivity Employee Charitable Match Program
Triangle Community Foundation, Inc.
United Technologies Research Center
University of Southern California
University of Virginia
Vanguard Charitable Endowment Program
Weinig Foundation, Inc.
Wells Fargo Advisors, LLC
Zarem Foundation
Zerhouni Family Charitable Foundation, Inc.
Anonymous (1)

We have made every effort to list donors accurately and according to their wishes. If we have made an error, please accept our apologies and contact the Development Office at 202.334.2431 or giving@nae.edu so we can correct our records.

*Deceased

QUICK REFERENCE GUIDE

Sunday, September 30

All events take place at the NAS Building, 2101 Constitution Avenue NW, unless otherwise noted.

10:00 am–4:00 pm	Registration	NAS 120
10:30 am–11:45 am	Brunch	West Lawn
10:30 am–11:45 am	Tax and Financial Planning Seminar (with brunch)	Members' Room
	PUBLIC PROGRAM	
12:00–2:00 pm	Induction Ceremony for NAE Class of 2018	Kavli Auditorium
2:30–4:00 pm	Awards Program	Kavli Auditorium
4:30–5:30 pm	Plenary Speakers	Kavli Auditorium
5:30–7:00 pm	Reception	West Lawn
6:00–9:00 pm	Golden Bridge Society Reception and Dinner (by invitation)	Offsite

Monday, October 1

7:00 am–2:00 pm	Registration	NAS 120
7:00–8:30 am	Continental Breakfast	West Lawn
7:00–8:30 am	Foreign Secretary's Breakfast (by invitation to the foreign members)	Members' Room
7:00–8:30 am	Home Secretary's Breakfast (by invitation)	Lecture Room
8:30–9:30 am	NAE Business Session	Kavli Auditorium
9:30 am–12:30 pm	Forum: Privacy and Security in the 21st Century – Who Knows and Who Controls?	Kavli Auditorium
12:30–1:30 pm	Lunch	West Lawn
12:45–1:30 pm	Testifying before Congress: A Tutorial (with lunch)	Lecture Room
2:00–5:00 pm	Section Meetings	NAS Building and Keck Center
6:30 pm	Reception	Mayflower Hotel, East Ballroom
7:30 pm–midnight	Dinner and Dancing	Mayflower Hotel, Grand Ballroom

The National Academies of
SCIENCES • ENGINEERING • MEDICINE

The nation turns to the National Academies of Sciences, Engineering, and Medicine for independent, objective advice on issues that affect people's lives worldwide.

www.national-academies.org